

NOTES TO USERS

This map is for use in administering the National Flood Insurance Program. It does not necessarily identify all areas subject to flooding, particularly from local drainage sources of small size. The community map repository should be consulted for possible updated or additional flood hazard information.

To obtain more detailed information in areas where **Base Flood Elevations (BFEs)** and/or **floodways** have been determined, users are encouraged to consult the **Flood Profiles and Floodway Data and/or Summary of Stillwater Elevations** tables contained within the Flood Insurance Study (FIS) report that accompanies this FIRM. Users should be aware that BFEs shown on the FIRM represent rounded whole-foot elevations. These BFEs are intended for flood insurance rating purposes only and should not be used as the sole source of flood elevation information. Accordingly, flood elevation data presented in the FIS report should be utilized in conjunction with the FIRM for purposes of construction and/or floodplain management.

Coastal Base Flood Elevations shown on this map apply only landward of 0.0' North American Vertical Datum of 1988 (NAVD 88). Users of this FIRM should be aware that coastal flood elevations are also provided in the Summary of Stillwater Elevations table in the Flood Insurance Study Report for this jurisdiction. Elevations shown in the Summary of Stillwater Elevations table should be used for construction and/or floodplain management purposes when they are higher than the elevations shown on the FIRM.

Boundaries of the **floodways** were computed at cross sections and interpolated between cross sections. The floodways were based on hydraulic considerations with regard to requirements of the National Flood Insurance Program. Floodway widths and other pertinent floodway data are provided in the Flood Insurance Study report for this jurisdiction.

Certain areas not in Special Flood Hazard Areas may be protected by flood control structures. Refer to Section 2.4 "Flood Protection Measures" of the Flood Insurance Study report for information on flood control structures in this jurisdiction.

The projection used in the preparation of this map was New Mexico State Plane Central Zone (NAD 83). The horizontal datum was GCS NAD83, CRS80 spheroid. Differences in datum, spheroid projection or State Plane FIPS zones used in the production of FIRM for adjacent jurisdictions may result in slight positional differences in map features across jurisdiction boundaries. These differences do not affect the accuracy of the FIRM.

Flood elevations on this map are referenced to the North American Vertical Datum of 1988. These flood elevations must be compared to structure and ground elevations referenced to the same vertical datum. For information regarding conversion between the National Geodetic Vertical Datum of 1929 and the North American Vertical Datum of 1988, visit the National Geodetic Survey website at <http://www.ngs.noaa.gov> or contact the National Geodetic Survey at the following address:

NGS Information Services
NGA, NAD83
National Geodetic Survey SSMC-3, #9202
1315 East-West Highway
Silver Spring, Maryland 20910-3282
(301) 713-2442

To obtain current elevation, description, and/or location information for **bench marks** shown on this map, please contact the Information Services Branch of the National Geodetic Survey at (301) 713-2442, or visit their website at <http://www.ngs.noaa.gov>.

Base map information shown on this FIRM was derived from multiple sources. Base map files were provided in digital format by the Valencia County Planning Department, the U.S. Geological Survey, and the City of Los Lunas. This information was compiled from orthophotography and field reconnaissance. Additional information was compiled at scales of 1:6,000 and 1:12,000 from aerial photography and the 7.5 minute quadrangles with dates ranging from 1989 to 2006.

This map reflects more detailed and up-to-date stream channel configurations than those shown on the previous FIRM for this jurisdiction. The floodways and floodways that were transferred from the previous FIRM may have been adjusted to conform to these new stream channel configurations. As a result, the Flood Profiles and Floodway Data tables in the Flood Insurance Study report which contains authoritative hydraulic data may reflect stream channel distances that differ from what is shown on the map.

Corporate limits shown on this map are based on the best data available at the time of publication. Because changes due to annexations or de-annexations may have occurred after this map was published, map users should contact appropriate community officials to verify current corporate limit locations.

Please refer to the separately printed **Map Index** for an overview map of the county showing the layout of map panels, community map repository addresses, and a listing of Communities table containing National Flood Insurance Program data for each community as well as a listing of the panels on which each community is located.

Contact the **FEMA Map Service Center** at 1-800-358-9616 for information on available products associated with this FIRM. Available products may include previously issued Letters of Map Change, a Flood Insurance Study report, and/or digital versions of this map. The FEMA Map Service Center may also be reached by Fax at 1-800-358-9620 and their website at <http://www.msc.fema.gov>.

If you have **questions about this map** or questions concerning the National Flood Insurance Program in general, please call 1-877-FEMA-MAP (1-877-336-2627) or visit the FEMA website at <http://www.fema.gov>.

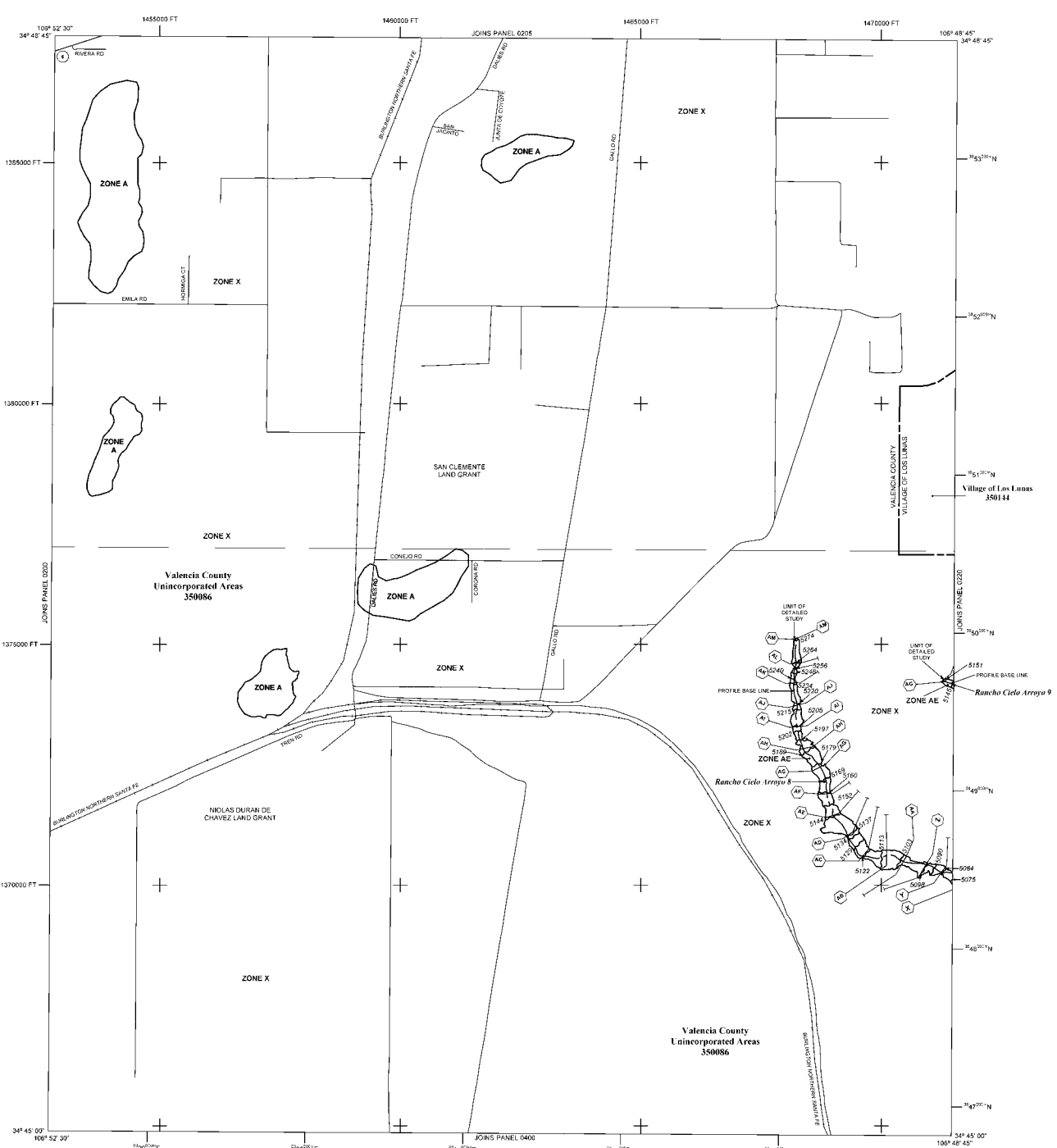

LEGEND

SPECIAL FLOOD HAZARD AREAS (SFHAs) SUBJECT TO Delineation by the 1% ANNUAL CHANCE FLOOD

The 1% annual chance flood (also known as the base flood) is the flood that has a 1% chance of being equaled or exceeded in any given year. The Special Flood Hazard Areas in the area subject to flooding by the 1% annual chance flood. Areas of Special Flood Hazard include Zone A, AE, AO, AR, V, and VE. The Base Flood Elevation is the water surface elevation of the 1% annual chance flood.

ZONE A
No base flood elevation determined. Base flood elevations determined.

ZONE AE
Flood depths of 1 to 3 feet (usually areas of ponds). Base Flood Elevation determined.

ZONE AO
Flood depths of 1 to 3 feet (usually sheet flow on sloping terrain). Average depths determined. The areas of actual lot flooding are also determined.

ZONE AR
Special Flood Hazard Area formerly protected from the 1% annual chance flood by a flood control system that was subsequently destroyed. Zone AR indicates that the former flood control system is being retained to provide protection from the 1% annual chance or greater flood.

ZONE V
Areas to be protected from 1% annual chance flood by a Federal flood protection system under construction. No Base Flood Elevation determined.

ZONE VE
Coastal flood zone with velocity hazard (wave action). No Base Flood Elevation determined.

FLOODWAY AREAS IN ZONE AE
The floodway is the channel of a stream plus any adjacent floodplain areas that must be kept free of encroachments so that the 1% annual chance flood can be carried without substantial increases in flood heights.

OTHER FLOOD AREAS

ZONE X
Areas of 0.2% annual chance flood areas of 1% annual chance flood with average depths of less than 1 foot or with changing areas less than 1 square mile, and areas protected by levees from 1% annual chance flood.

OTHER AREAS

ZONE D
Areas determined to be outside the 0.2% annual chance floodplain. Areas in which flood heights are undetermined and probable.

COASTAL BARRIER RESOURCES SYSTEM (CBRS) AREAS

OTHERWISE PROTECTED AREAS (OPAs)

CBRS areas and OPAs are normally located within or adjacent to Special Flood Hazard Areas.

Map Symbols:

- Floodway boundary
- Zone D boundary
- CBRS and OPA boundary
- Boundary dividing Special Flood Hazard Areas of different Base Flood Elevations, flood depths or flood velocities.
- Base Flood Elevation (in feet and value: elevation in feet)
- Base Flood Elevation value where uniform within zone: Elevation in feet
- Referenced to the North American Vertical Datum of 1988
- Cross-section line
- Transient line
- 97° 07' 30", 32° 22' 30"
- 1000 feet and state: New Mexico State Plane coordinate system
- Critical zone (FIPS 3000), Transverse Mercator Projection
- Bench mark (see explanation in notes to users section of this FIRM panel)
- M.S. River Mile

MAP REPOSITORIES
Refer to Map Repositories List on Map Index.

EFFECTIVE DATE OF COUNTYWIDE FLOOD INSURANCE RATE MAP PANEL
AUGUST 19, 2010

EFFECTIVE DATE(S) OF REVISION(S) TO THIS PANEL

For community map revision history prior to countywide mapping, refer to the Community Map History table located in the Flood Insurance Study report for this jurisdiction.

To determine if flood insurance is available in this community, contact your insurance agent or call the National Flood Insurance Program at 1-800-338-6420.

MAP SCALE 1" = 1000'

0 500 1000 2000 FEET
0 500 1000 2000 METERS

NATIONAL FLOOD INSURANCE PROGRAM

PANEL 0215E

FIRM

FLOOD INSURANCE RATE MAP

VALENCIA COUNTY, NEW MEXICO AND INCORPORATED AREAS

PANEL 215 OF 725

(SEE MAP INDEX FOR FIRM PANEL LAYOUT)

CONTAINS:	COMMUNITY	NUMBER	PANEL	SHEET
JOHN LUNAS VILLAGE, NM	350146	0215	1	1
VALLEJO VILLAGE, NM	350096	0215	1	1

Version 1.0 - Map: The Map Number identifies the official set of maps in a given map set. The Map Number identifies the official set of maps in a given map set. The Map Number identifies the official set of maps in a given map set.

MAP NUMBER
350810215E

EFFECTIVE DATE
AUGUST 19, 2010

Federal Emergency Management Agency